

BIG GAME COMPRESSED AIR SAFETY



PLEASE READ CAREFULLY - COMPRESSED AIR CAN KILL !

• You may only fill bottles which meet the criterion of current legislation and safety standards in force in the UK, as detailed in the accompanying UKPSF (UK Paintball Sports Federation) document : "High Pressure Air - Paintball Safety Information Guide (HPA 1)"

• Every bottle you wish to fill will be checked prior to use by trained event air staff – this is to check that your bottle contains the correct safety markings, is within test date, and has no obvious physical damage. Your bottle will be given an identifying sticker after the inspection.

This is NOT an actual or implied guarantee that your air bottle or regulator are safe, merely that trained staff have checked that there are no outward signs that the bottle is unsafe to fill

• Only players who have read these guidelines are permitted to use the Air Filling System. Event air staff will be on hand to oversee all air filling, and will stop any player who they can clearly see is unfamiliar or uncomfortable with the air filling procedure. Staff may refuse access to the Air Filling System if they suspect you have not fully familiarized yourself with these guidelines.

• You must be 18 or over to use the Air Filling System. If you are under 18 you must have your bottle filled only by an adult (18+)

• The Air Filling System consists of multiple fill panels, clearly marked with one of two output pressures. These will be marked 3000psi Only and 4500psi Only. Always take care and ensure you are filling from the correct panel for your bottle. 3000psi bottles must **NEVER** be filled from a 4500psi output panel.

Air Filling System operation:

1. Identify correct output pressure fill panel.

2. Connect the air bottles to the air panel hose (see pic) - pull back the collar on the attachment at the end of the hose and insert fill nipple (see pic) on your regulator. Push the collar on the hose forward – make sure the hose and the fill nipple are securely connected before proceeding.

3. Identify the filling lever. Make sure you can see your bottle pressure gauge (on your regulator) - Push down on the filling lever and begin the air delivery. As the bottle is filling carefully watch your pressure gauge – make sure the pressure does not go over the allowable pressure of the bottle being filled.

If you notice an air leak on any part of the Air Filling System or your bottle at any time during the filling procedure, release the filling lever and immediately alert a member of staff.

4. To stop air delivery when the bottle is full, or at any time, simply **RELEASE** the filling lever. This will cease delivery, close your fill nipple, and "dump" the small amount of pressurised air remaining between your fill nipple and the system (in the hose)

5. Disconnect your air bottle by pulling back the the collar on the hose attachment, and remove the bottle fill nipple.

If you have ANY concerns over your ability to complete the above procedure safely, or are in the least uncomfortable with the use of the equipment, do not be afraid to immediately ask a member of staff for assistance. We understand **everyone has to learn, everyone has to be safe. Look after yourself, your fellow paintballers, and your equipment.**

Additional Info on safe use of compressed air equipment

Regularly check the test date on your paintball marker air tank. Proceed with filling only if the tank is within the test date. If the tank is out of date, have it inspected and recertified by a company qualified to recertify high pressure air tanks.

• Inspect the exterior of the tank for damage. Do not use if damaged. If the tank is damaged, have it inspected and certified for use by a company qualified to recertify high pressure air tanks.

• Inspect the fill nipple on the marker. Replace if damaged.

• Wipe the nipple with a clean cloth. A slight amount of **non oil-based** lubricant on the cloth may help to make it easier to connect and disconnect the fill coupling. **NEVER USE** oil based lubricants. 3 in 1, WD40, and other oil based products are **NOT SUITABLE** for cleaning or lubricating compressed air bottles, regulators or components. Use only lubricants approved for use on high pressure air components.

• Verify that the pressure gauge on the marker is operable and indicates pressure accurately.

• **NEVER** attempt to fill the paintball marker air tank to a pressure higher than its rated pressure.

• Cover the nipple with a dust cap.

There is always a risk involved in filling high pressure air tanks. Always respect the power of high pressure compressed air. Personal injury and death can and do occur from the misuse of high pressure compressed air.

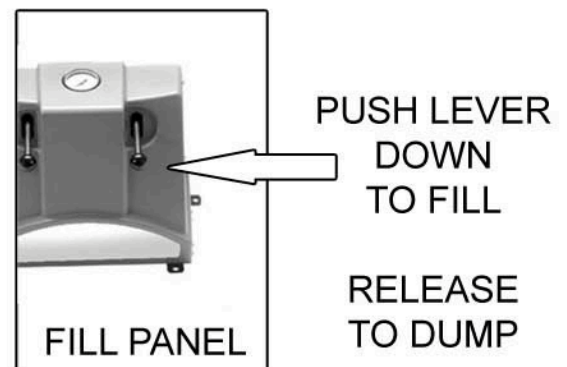
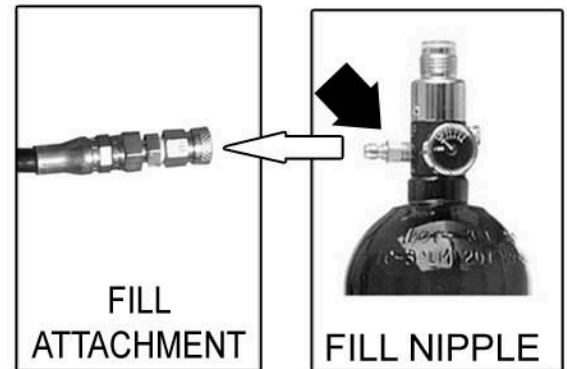

**THINK SAFE.
BE SAFE!**